

WHITEHORSE NORTH TRAIL PLAN MAP

October 2022

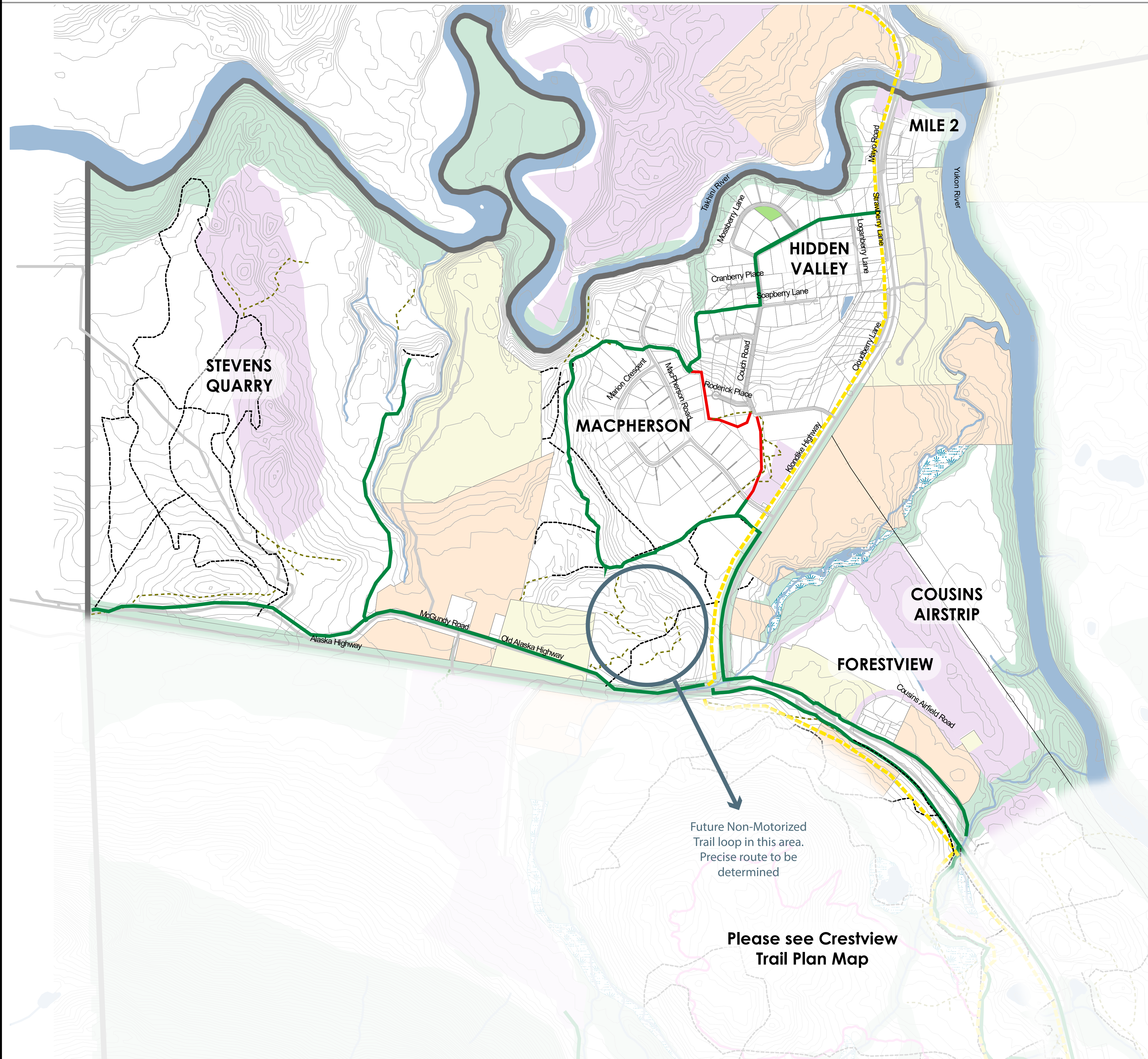

Legend

Trail Designations

- Proposed Motorized Multi-Use (MMU) Trails
- Trans Canada Trail
- Proposed Non-motorized Multi-use Trails

Existing Trails/Corridors

- Roads
- Right-of-Way
- Double Track Trails & Old Roads
- Single Track Trails

Areas of Interest

- Waterbodies
- Streams
- Industrial Area
- Third Party Land Dispositions
- City Parks
- Environmentally Sensitive Areas
- Environmental Protection
- Wetlands
- City Boundary

First Nations Settlement Land

- Kwanlin Dün First Nation
- Ta'an Kwäch'än Council

LEFS
ASSOCIATES



0 1 2Km



*Snowmobiles are permitted on motorized multiple use trails and any other area of the city that is not excluded (such as Environmentally Sensitive Areas, ski trails or Millennium Trail) provided they do not damage vegetation or ground. See Snowmobile Bylaw 2012-01 or <https://www.whitehorse.ca/departments/bylaw-services/snowmobiles> for more information.